

PCE

Connection
to the future



PEGASUS [air.]

PEGASUS [base]



POWERBOX



PEGASUS^[air]

TWO ALL-ROUNDERS WITH



- **Compact, modular design** allows many different versions
- IP44 splashproof
- For use as a suspended or mobile distribution box
- The mounting dimensions of each component are **optimally aligned** so that a large number of assembly options are available on 6 mounting surfaces.
- **Combination options:** 16A 3p to 32A 5p CEE sockets, a variety of schuko and similiar sockets, fused or non-fused, with integrated air supply etc.
- **Many different fields of application:** from practical construction site distribution box to the distribution box for events, as an overhead energy supply for various working environments in production, as well as in workshops or for domestic use.
- **Entries**
Cable glands and wiring for terminals on cover plates (even for several circuits), CEE flanged plugs, device cabling
- **Outlets**
CEE sockets up to 32A, schuko socets (according to Austrian/German, Belgium/French, Danish, English or Swiss standards), IT sockets (LAN, Tel, ...)

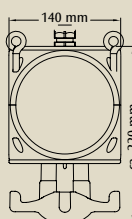
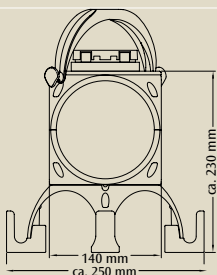
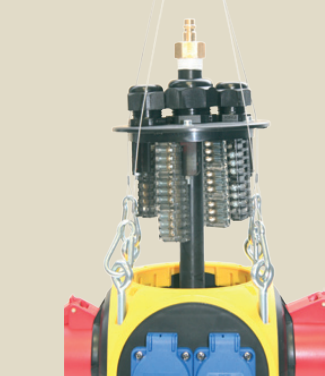

PEGASUS [base]

MANY FIELDS OF APPLICATION

PEGASUS BASE

- New developed bow-type handle
 - ergonomic
 - with integrated position detent and cable clip bracket
 - made of high-quality plastic material
- Anti-slip feet with 4 rubber stoppers
 - for firm stability
 - can also be used as coiling option for cable connections



PEGASUS AIR

- **Special anchor handle**
serves as handle when inserting plugs and can also be used to hang up small tools.





PEGASUS [base]

- # Practical, robust and compact distribution box made of shock-resistant polyamide
- # dimensions: LxWxH: 140x140x220mm
- # With plastic carrying handle
- # Max. rated current of 32A
- # Max. 6 mounting surfaces
(4 standard slots, individual placement also possible with universal plates)

THERMOPLASTIC INSULATED DISTRIBUTION

VERSION: NON-FUSED, WITH CARRYING HANDLE AND BASE

9034001 4 CEE-sockets 32A 5p 400V
2m cable H07RN-F 5G4 with CEE-plug 32A 5p 400V

9034002 4 CEE-sockets 16A 5p 400V
2m cable H07RN-F 5G2,5 with CEE-plug 16A 5p 400V

9034003 2 CEE-sockets 16A 5p 400V
2 sockets (DIN49440) 16A 250V
2m cable H07RN-F 5G2,5 with CEE-plug 16A 5p 400V



9034004 1 CEE-socket 16A 5p 400V
3 sockets (DIN49440) 16A 250V
2m cable H07RN-F 5G2,5 with CEE-plug 16A 5p 400V

9034005 8 sockets (DIN49440) 16A 250V
2m cable H07RN-F 5G2,5 with CEE-plug 16A 5p 400V

9034006 4 sockets (DIN49440) 16A 250V
2m cable H07RN-F 5G2,5 with CEE-plug 16A 5p 400V

9034007 4 sockets (DIN49440) 16A 250V
2m cable H07RN-F 3G2,5 with schuko plug
16A 250V

9034008 3 CEE-sockets 32A 5p 400V
1 CEE-plug 32A 5p 400V

9034009 3 CEE-sockets 16A 5p 400V
1 CEE-plug 16A 5p 400V

9034010 1 CEE-socket 16A 5p 400V
2 sockets (DIN49440) 16A 250V
1 CEE-plug 16A 5p 400V



9034011 6 sockets (DIN49440) 16A 250V
1 CEE-plug 16A 5p 400V



- ✦ Window for up to 4 modules
- ✦ IP44 splashproof, ready wired for connection
- ✦ Suitable for construction sites, workshops, agriculture, domestic, industrial, commercial and for events
- ✦ Anti-tilt bracket as standard with 4 rubber stoppers, can also be use to coil cables
- ✦ Housing colours: red/black and yellow/black



BOXES – MOBILE

SERIES PEGASUS 9034XXX

VERSION: FUSED, WINDOW WITH 4 MODULES, CARRYING HANDLE AND BASE

9034030 1 CEE-socket 32A 5p 400V
1 CEE-socket 16A 5p 400V
2 sockets (DIN49440) 16A 250V
2m cable H07RN-F 5G4 with CEE-plug 32A 5p 400V



9034031 2 CEE-sockets 16A 5p 400V
2 sockets (DIN49440) 16A 250V
2m cable H07RN-F 5G4 with CEE-plug 32A 5p 400V

9034032 1 CEE-socket 16A 5p 400V
2 sockets (DIN49440) 16A 250V
2m cable H07RN-F 5G4 with CEE-plug 32A 5p 400V

9034033 6 sockets (DIN49440) 16A 250V
2m cable H07RN-F 5G4 with CEE-plug 32A 5p 400V

9034034 3 sockets (DIN49440) 16A 250V
2m cable H07RN-F 5G2,5 with CEE-plug 16A 5p 400V

9034050 2 CEE-sockets 32A 5p 400V
1 RCD 63A/4/0,03A over all outlets
2m cable H07RN-F 5G4 with CEE-plug 32A 5p 400V

9034051 2 CEE-sockets 16A 5p 400V
1 RCD 40A/4/0,03A over all outlets
2m cable H07RN-F 5G2,5 with CEE-plug 16A 5p 400V

9034052 1 CEE-socket 16A 5p 400V
3 sockets (DIN49440) 16A 250V
1 RCD 40A/4/0,03A over all outlets
2m cable H07RN-F 5G2,5 with CEE-plug 16A 5p 400V

9034053 6 sockets (DIN49440) 16A 250V
1 RCD 40A/4/0,03A over all outlets
2m cable H07RN-F 5G2,5 with CEE-plug 16A 5p 400V

9034054 3 sockets (DIN49440) 16A 250V
1 RCD 40A/4/0,03A over all outlets
2m cable H07RN-F 5G2,5 with CEE-plug 16A 5p 400V



9034055 3 sockets (DIN49440) 16A 250V
1 RCD 25A/2/0,03A over all outlets
2m cable H07RN-F 3G2,5 with schuko plug 16A 250V



PEGASUS [air]

- # Practical, robust and compact distributor made of shock-resistant polyamide
- # Dimensions: LxWxH: 140x140x230mm
 - # With 4 ring bolts for ceiling fastening (accessories: complete suspension kit)
 - # With ergonomic anchor handle on the bottom of the housing
 - # Max. rated current of 32A
 - # Max. 6 mounting surfaces (4 standard dots, individual placement • also possible with universal plates)

THERMOPLASTIC INSULATED DISTRIBUTION BOXES

VERSION: NON-FUSED, WITH 4 RING BOLTS AND ANCHOR HANDLE

9033001	CEE-sockets 32A 5p 400V CEE-sockets 16A 5p 400V 1 M32 and 1 M25 on top	VC-rail for CEE 32A VC-rail for schuko sockets	9033005	1 CEE-socket 16A 5p 400V 3 sockets (DIN49440) 16A 250V 1 VC-rail 5p 1 M25 on top
9033002	1 CEE-socket 32A 5p 400V 1 CEE-socket 16A 5p 400V 2 sockets (DIN49440) 16A 250V 1 M32 and 1 M25 on top	VC-rail for CEE 32A VC-rail for CEE 16A	9033006	8 sockets (DIN49440) 16A 250V 1 VC-rail 5p (400V entry) 1 M25 on top
9033003	4 CEE-sockets 16A 5p 400V 1 M25 on top	1 VC-rail 5p	9033007	4 sockets (DIN49440) 16A 250V 1 VC-rail 5p (400V entry) 1 M25 on top
9033004	2 CEE-sockets 16A 5p 400V 2 sockets (DIN49440) 16A 250V 1 M25 and 1 M20 on top	1 VC-rail 5p for CEE 1 VC-rail 3p schuko sockets	9033008	4 sockets (DIN49440) 16A 250V 1 VC-rail 3p (230V entry) 1 M20 on top

VERSION: FUSED, WINDOW WITH 4 MODULES, RING BOLTS AND ANCHOR HANDLE

9033030	1 CEE-socket 32A 5p 400V 1 CEE-socket 16A 5p 400V 2 sockets (DIN49440) 16A 250V 1 VC-rail 5p 1 M32 on top	unprotected 1 MCB 16A 3p C 1 MCB 16A 1p C	9033032	1 CEE-socket 16A 5p 400V 2 sockets (DIN49440) 16A 250V 1 VC-rail 5p 1 M32 on top	1 MCB 16A 3p C 1 MCB 16A 1p C
9033031	2 CEE-sockets 16A 5p 400V 2 sockets (DIN49440) 16A 250V 1 VC-rail 5p 1 M32 on top	1 MCB 16A 3p C 1 MCB 16A 1p C	9033050	2 CEE-socket 16A 5p 400V 2 sockets (DIN49440) 16A 250V 1 RCD 40A/4/0,03A over all outlets 1 VC-rail 5p 1 M25 on top	unprotected unprotected



- ✦ Window for up to 4 modules
 - ✦ IP44 splashproof, ready wired for connection
- ✦ Suitable for workshops, agriculture, domestic, industrial, commercial and for events
 - ✦ Also suitable for combination of electricity and air ½"
- ✦ housing colours: red/black and yellow/black



— WITH SUSPENDED HOOK

SERIES PEGASUS 9033XX

9033051 1 CEE-socket 16A 5p 400V
 3 sockets (DIN49440) 16A 250V
 1 RCD 40A/4/0,03A over all outlets
 1 VC-rail 5p
 1 M25 on top



unprotected
 unprotected

9033052 3 sockets (DIN49440) 16A 250V
 1 RCD 40A/4/0,03A over all outlets
 1 VC-rail 5p (400V entry)
 1 M25 on top

unprotected

9033053 3 sockets (DIN49440) 16A 250V
 1 RCD 25A/2/0,03A over all outlets
 1 VC-rail 3p 16A (230V entry)
 1 M20 on top

unprotected

VERSION: FUSED, WINDOW WITH 4 MODULES, RING BOLTS AND COMBINATION OF ELECTRICITY AND AIR ½"

9033070 4 CEE-sockets 16A 5p 400V
 1 VC-rail 5p
 1 M25 on top
 1 compression air tube size ½"

unprotected

9033072 8 sockets (DIN49440) 16A 250V
 1 VC-rail (400V entry)
 1 M20 on top
 1 compression air tube size ½"

unprotected

9033071 1 CEE-socket 16A 5p 400V
 3 sockets (DIN49440) 16A 250V
 1 VC-rail 5p
 1 M25 on top
 1 compression air tube size ½"

unprotected
 unprotected

9033073 4 sockets (DIN49440) 16A 250V
 1 VC-rail 3p (230V entry))
 1 M20 on top
 1 compression air tube size ½"

unprotected



THERMOPLASTIC INSULATED DISTRIBUTION BOX – SUSPENDED VERSION – EMPTY BOX

9033999 included in delivery

- housing
- 4 blind covers (side)
- 2 blind covers (cover)
- ring bolts – premounted
- housing screws – loose
- anchor handle incl. screws
- VC-rail for entry max. 5p

accessories for suspended version
9033-1 suspension kit (4x)

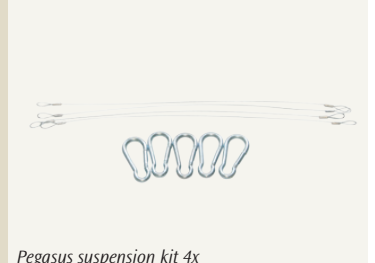

PCE

PC ELECTRIC Ges.m.b.H.

A-4973 St. Martin/Innkreis
Diesseits 145
AUSTRIA - EUROPE
Tel. +43 / 7751 / 61220
Fax +43 / 7751 / 6969
e-mail: office@pcelectric.at
www.pcelectric.at