



## bates® STAGE PIN DEVICES

The industry standard stage pin, built in the USA.

- Pins crafted from solid brass rods to tolerance  $\pm .005"$
- Male and female pins "float," ensuring positive alignment and contact.
- Precision slotted and crimped female contacts are sized to provide spring contact, even to damaged pins.
- Clearly marked pressure terminals reduce work load.
- 2 piece, multi-position strain relief inserts accommodate a full range of wiring configurations
- Clear or colored tops available.
- High-temperature, high impact-resistant thermoplastic housing.

### bates Inline CLEAR

20F	FEMALE BARREL TERMINAL (STANDARD)
20M	MALE BARREL TERMINAL
20F-RT	FEMALE RING TERMINAL
20M-RT	MALE RING TERMINAL
20F-CP OEM	FEMALE CRIMP TERMINAL
20M-CP OEM	MALE CRIMP TERMINAL
20M-DB OEM	2FER

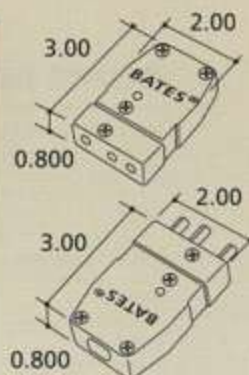

20A Bates Panel Mount cutout size  
0.760" X  
2.020"  
(actual size)

### bates Panel Mounts

- Male and female pins "float" to allow for smooth connecting action
- Self-grounding mounting clip eliminates the need for a separate ground wire.

20FR	FEMALE BARREL TERMINAL
20MR	MALE BARREL TERMINAL
20FR-RT	FEMALE, RING TERMINAL
20MR-RT	MALE, RING TERMINAL

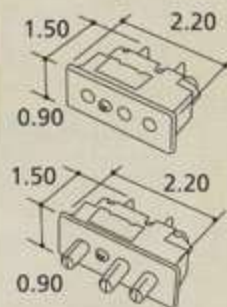

## GROUP 5®

Machined from high temperature phenolic material, GROUP 5 products have all the features of BATES products excepting clear covers and strain relief. All Group 5 stagepin connectors and panel mount receptacles are **ETL listed**.

### GROUP 5 Inline

DOUBLE SET SCREW

G20F	FEMALE
G20M	MALE
G20F-FU	FEMALE FUSED
G20M-FU	MALE FUSED

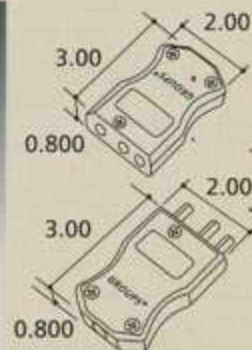

## bates Inline ■

DOUBLE SET SCREW

60F FEMALE

60M MALE

RING TERMINAL

60F-RT FEMALE

60M-RT MALE

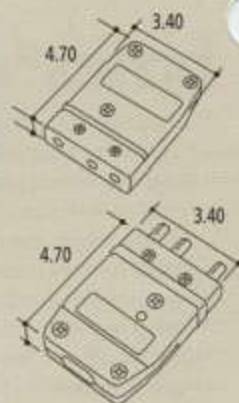

## bates Panel Mounts ■ ■ ■

DOUBLE SET SCREW

60FR-DSS FEMALE

60MR-DSS MALE

RING TERMINAL

60FR FEMALE

60MR MALE

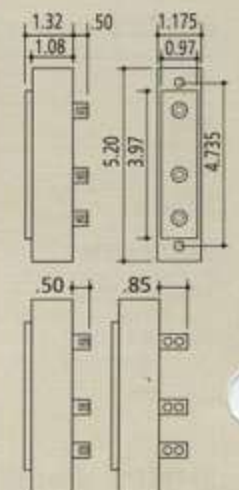

60MR

60FR

CUT OUT SIZE = 1.0" X 4.0"

## GROUP 5 Inline ■

DOUBLE SET SCREW

G60F FEMALE

G60M MALE

G60F-FU FEMALE - FUSED

G60M-FU MALE - FUSED

G60M-DB MALE - 2 FER

RING TERMINAL

G60F-RT FEMALE

G60M-RT MALE

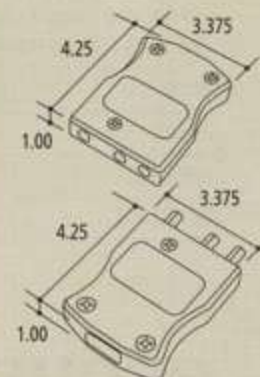

G60M

G60F



DOUBLE SET SCREW



(RT) RING TERMINAL



(DB) ENLARGED CABLE EXIT

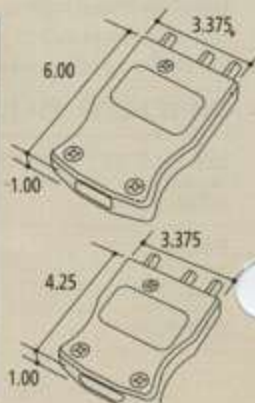

G60M -FU

G60M-DB

## bates Inline ■

DOUBLE SET SCREW (STANDARD)

100F	FEMALE
100M	MALE

RING TERMINAL

100F-RT	FEMALE
100M-RT	MALE

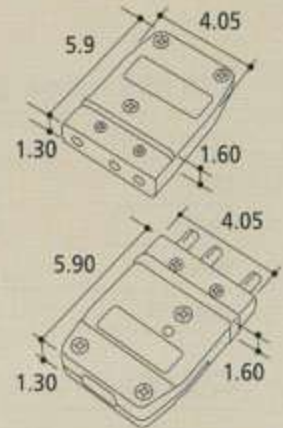

## bates Panel Mounts ■ ■ ■

RING TERMINAL (STANDARD)

100FR	FEMALE
100MR	MALE

DOUBLE SET SCREW

100FR-DSS	FEMALE
100MR-DSS	MALE

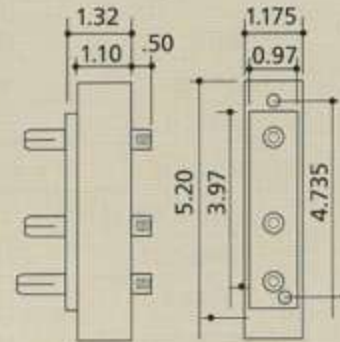

CUTOUT SIZE 1" X 4"

## GROUP 5 Inline ■

DOUBLE SET SCREW (STANDARD)

G100F	FEMALE
G100M	MALE
G100F-FU	FEMALE FUSED
G100M-FU	MALE FUSED
G100M-DB	MALE 2 FER

RING TERMINAL

G100F-RT	FEMALE
G100M-RT	MALE

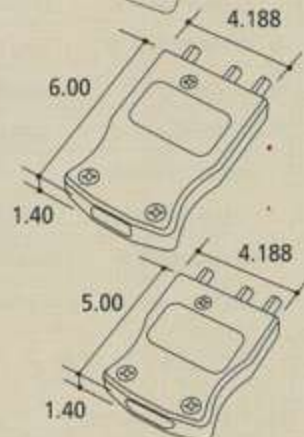
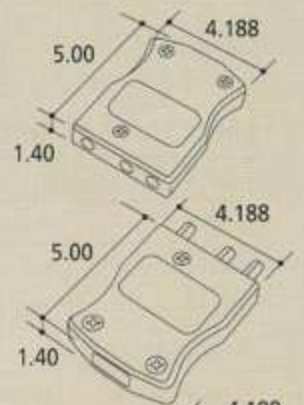

DOUBLE SET SCREW



(RT) RING TERMINAL



(DB) ENLARGED CABLE EXIT

## bates Inline ■ ■

DOUBLE SET SCREW

106F	FEMALE, BLACK
106M	MALE, BLACK
106F-H	FEMALE, YELLOW
106M-H	MALE, YELLOW

## bates Panel Mounts ■ ■

RING TERMINAL (STANDARD)

106FR	FEMALE, BLACK
106MR	MALE, BLACK
106FR-H	FEMALE, YELLOW
106MR-H	MALE, YELLOW

DOUBLE SET SCREW

106FR-DSS	FEMALE, BLACK
106MR-DSS	MALE, BLACK
106FR-DSS-H	FEMALE, YELLOW
106MR-DSS-H	MALE, YELLOW

## GROUP 5 Inline ■ ■

DOUBLE SET SCREW

G106F	FEMALE, BLACK
G106M	MALE, BLACK
G106F-H	FEMALE, YELLOW
G106M-H	MALE, YELLOW
G106F-DB-H	FEMALE 2 FER, YELLOW
G106M-DB-H	MALE 2 FER, YELLOW
G106F-FU-H	FEMALE FUSED, YELLOW
G106M-FU-H	MALE FUSED, YELLOW

RING TERMINAL

G106F-RT-H	FEMALE, YELLOW
G106M-RT-H	MALE, YELLOW

GROUP 5 PANEL MOUNTS AVAILABLE ON REQUEST



DOUBLE SET SCREW



(RT) RING TERMINAL



(DB) ENLARGED CABLE EXIT

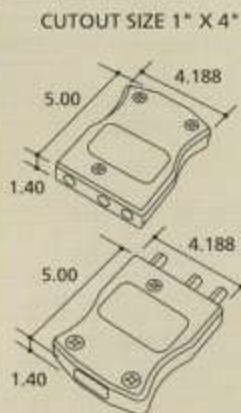
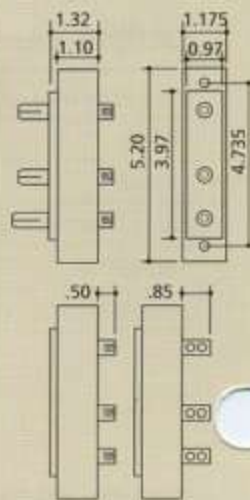
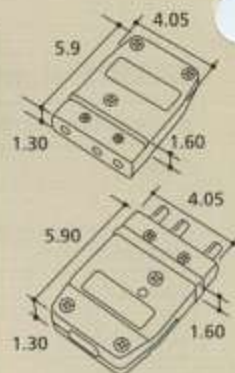

CUTOUT SIZE 1" X 4"

## CL Series Inline - 400A/600V

CL Series cam type devices assemble easily with hand tools and offer superior durability and safety. Built with copper contacts for better performance and reduced heat rise, the CL Series offers universal strain relief for all wire gauges. One housing fits #6 - 4/0 cable. UL and cUL listed. 

All Advanced CL Series, CLS Series and CLM Series products mate precisely with all other manufacturers' cam products.

DOUBLE SET SCREW - COPPER (STANDARD)

CL40F	2/0-4/0 FEMALE
CL40M	2/0-4/0 MALE
CL20F	#2 TO 2/0 FEMALE
CL20M	#2 TO 2/0 MALE
CL2F	#6 TO #2 FEMALE
CL2M	#6 TO #2 MALE

\*TO ORDER BRASS, ADD "B" TO THE PRODUCT NUMBER

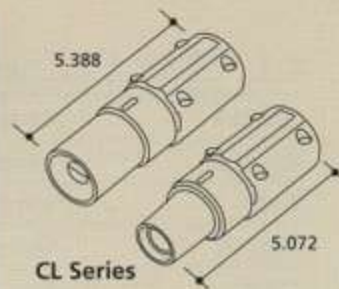

CL Series 2-piece hard shell case and connector are easily field-assembled with simple hand tools.

## CLS Series Inline - 400A/600V

CLS Series inline connectors have a non-conductive retaining screw which passes through the metal contact and fastens at both ends to the retaining ring, providing maximum resistance to excessive torque loading. Constructed of solid weatherproof materials, all CLS and CLM products are UL Listed, CSA listed, NEMA 3R and NEMA 4R rated for wet locations. 

DOUBLE SET SCREW - BRASS (COPPER\*)

CLS40FB	2/0-4/0 FEMALE
CLS40MB	2/0-4/0 MALE
CLS20FB	#2 TO 2/0 FEMALE
CLS20MB	#2 TO 2/0 MALE
CLS2FB	#6 TO #2 FEMALE
CLS2MB	#6 TO #2 MALE

\*TO ORDER COPPER CONTACTS, ELIMINATE "B" IN PRODUCT NO.



## CLM Series Inline - 150A/600V

The CLM Series "Mini" includes an exclusive double set screw connection and offers all the weathertight features of the CLS Series. The connector's wire pocket accepts #8 to #2 Type W cable, and is specifically engineered and manufactured for loads to 150A.

DOUBLE SET SCREW

CLM2F	#8 TO #2 FEMALE
CLM2M	#8 TO #2 MALE
CLM4F	#8 TO #4 FEMALE
CLM4M	#8 TO #4 MALE



**CL, CLM, CLS Series Adapters** ■ □ ■ ■ ■ ■ ■ ■ ■ ■

CA3M-E	Reverse Hard 3fer	■	F-M-M-M
CA3M-B	Reverse Hard 3fer	□	F-M-M-M
CA3F	Hard 3fer		M-F-F-F
CDMM	Male to Male Coupler		M-M
CDFF	Fem. to Fem. Coupler		F-F
CPT	Paralleling T		M-M-F
CTT	Tapping T		M-F-F
CLMADFF	Cam Reducer		400A F - 150A F
CLMADMF	Cam Reducer		400A M - 150A F
CLMADFM	Cam Reducer		400A F - 150A M
CLMADMM	Cam Reducer		400A M - 150A M
CLAF	Cam to Mole Lok		CAM M TO MOLE LOK F
CLAM	Cam to Mole Lok		CAM F TO MOLE LOK M



**CLS Series Assembled Adapters** ■ □ ■ ■ ■ ■ ■ ■ ■ ■

CPTMST	Soft Paralleling T		M-M-M
CPTFST	Soft Paralleling T		M-M-F
CTTFST	Soft Tapping T		M-F-F
CTTMST	Soft Tapping T		M-F-M
CA3MST	Reverse Soft 3fer		F-M-M-M
CA3FST	Soft 3fer		M-F-F-F



## CLM Series

### "Mini" Panel Mounts - 150A/600V

#### THREADED STUD

CLMMRS #8 TO #2 FEMALE

CLMFRS #8 TO #2 MALE

#### DOUBLE SET SCREW

CLMMR #8 TO #2 FEMALE

CLMFR #8 TO #2 MALE

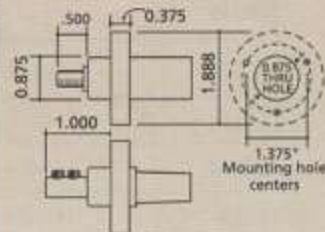

## CL Series

### Panel Mounts - 400A/600V

#### THREADED STUD

CL40FRS FEMALE

CL40MRS MALE

#### DOUBLE SET SCREW - COPPER (OR BRASS)

CL40FR 2/0-4/0 FEMALE

CL40MR 2/0-4/0 MALE

CL20FR #2 TO 2/0 FEMALE

CL20MR #2 TO 2/0 MALE

\*TO ORDER BRASS, ADD "B" TO THE PRODUCT NUMBER

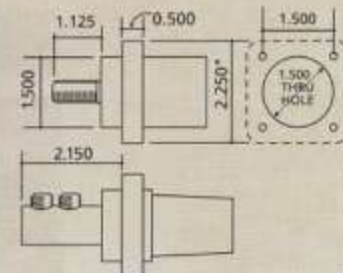

### Bus Bar Mounts - 400A/600V

Solid single-piece machined brass construction with molded shroud

CL40FR-ANGLE FEMALE

CL40MR-ANGLE MALE

CL40FR-OFFSET FEMALE

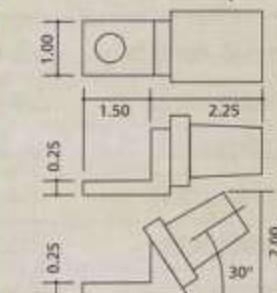

## CL, CLS Series Protective Covers

Manufactured in UV-resistant polycarbonate, all snap back plastic covers are made with stainless steel offset, spring and pin. Designed for surface mount or internal mount, the new snap back plastic covers are fully gasketed and NEMA 3R rated for weathertight protection.

CL40WTC-L SNAP BACK PLASTIC COVER\*3R RATED

CL40WTC-S SNAP BACK PLASTIC COVER\*\*3R RATED

CL40ZFLC SNAP BACK METAL COVER

CL40FC FEMALE PROTECTIVE CAP w/LANYARD

CL40MC MALE PROTECTIVE CAP w/LANYARD

CLMFC MINI FEMALE PROTECTIVE CAP w/LANYARD

CLMMC MINI MALE PROTECTIVE CAP w/LANYARD



\*FOR STANDARD METAL DISTRO PANEL - THICKNESS .070-.090"

\*\*FOR THERMOPLASTIC DISTRO PANEL - WALL THICKNESS .370-.400"



## Tools

15CLM	MALE CONNECTOR EXTRACTOR 150A
15CLF	FEMALE CONNECTOR EXTRACTOR 150A
16CLM	MALE CONNECTOR EXTRACTOR 400A
16CLF	FEMALE CONNECTOR EXTRACTOR 400A
CLSPRESS	COME-ALONG TOOL
500072	CLS FEMALE REFORMING TOOL - 400A

**new**



RESTORES DAMAGED  
FEMALE CAM TYPE  
CONTACTS



CLSPRESS

## Product Parts and Accessories

GLUG40-SLD	2/D SISTER LUG CRIMP
GLUG40-SS	2/D SISTER LUG SET SCREW
200022CL	#2 AWG WIRE SHOE for CL Series
200019	CLM SET SCREW FOR #6 WIRE
500017PLT	CLS SET SCREW
200060	CLM SET SCREW
200012	20A STAGEPIN WIRE SHOE Bag of 300
200056-8	20A 2FER PIN TERMINAL
200009	20A TERMINATION SCREWS
200022	100A STAGEPIN WIRE SHOE
200021	60A STAGEPIN WIRE SHOE Bag of 150
110040	CLM RETAINING SCREW
110037	CLS RETAINING SCREW
300075	CL / CLS COPPER SHIM
300076M	CLM STRAIN RELIEF WIRE
300076	CLS STRAIN RELIEF WIRE

Sister lugs are die cast in manganese bronze for maximum tensile strength. Precisely machined slot ensures perfect alignment with bus bar for better contact. Optional double set screw available



GLUG40-SLD GLUG40-SS



# MANUFACTURER / PRODUCT CROSS REFERENCE

ADI CL-SERIES 2-pc. Hard shell	ADI CLS-SERIES (Rubber) Nema 3R & 4	ECT / LEVITON	CROUSE HINDS CAM-LOK™
CL2M-A	CLS2MB-A	N/A	N/A
CL2M-B	CLS2MB-B	N/A	N/A
CL2M-C	CLS2MB-C	N/A	N/A
CL2M-D	CLS2MB-D	N/A	N/A
CL2M-E	CLS2MB-E	N/A	N/A
CL2F-A	CLS2FB-A	N/A	N/A
CL2F-B	CLS2FB-B	N/A	N/A
CL2F-C	CLS2FB-C	N/A	N/A
CL2F-D	CLS2FB-D	N/A	N/A
CL2F-E	CLS2FB-E	N/A	N/A
CL20M-A	CLS20MB-A	16D55-220M/16D22E	E1016-8350
CL20M-B	CLS20MB-B	16D55-220M/16D22W	E1016-8355
CL20M-C	CLS20MB-C	16D55-220M/16D22R	E1016-8352
CL20M-D	CLS20MB-D	16D55-201M/16D22B	E1016-8356
CL20M-E	CLS20MB-E	16D55-220M/16D22G	E1016-8354
CL20F-A	CLS20FB-A	16D55-220F/16D31E	E1016-8375
CL20F-B	CLS20FB-B	16D55-220F/16D31W	E1016-8380
CL20F-C	CLS20FB-C	16D55-220F/16D31R	E1016-8377
CL20F-D	CLS20FB-D	16D55-220F/16D31B	E1016-8381
CL20F-E	CLS20FB-E	16D55-220F/16D31G	E1016-8379
CL40M-A	CLS40MB-A	16D55-204M/16D24E	E1016-8362
CL40M-B	CLS40MB-B	16D55-204M/16D24W	E1016-8367
CL40M-C	CLS40MB-C	16D55-204M/16D24R	E1016-8364
CL40M-D	CLS40MB-D	16D55-204M/16D24B	E1016-8368
CL40M-E	CLS40MB-E	16D55-204M/16D24G	E1016-8366
CL40F-A	CLS40FB-A	16D55-204F/16D33E	E1016-8387
CL40F-B	CLS40FB-B	16D55-204F/16D33W	E1016-8392
CL40F-C	CLS40FB-C	16D55-204F/16D33R	E1016-8389
CL40F-D	CLS40FB-D	16D55-204F/16D33B	E1016-8393
CL40F-E	CLS40FB-E	16D55-204F/16D33G	E1016-8391

ADI (Brass)	ADI (Copper)	ECT / LEVITON®	CROUSE HINDS®
CL40MRSB-A	CL40MRS-A	16RTS-104M/16R23E	E1016-1600S
CL40MRSB-B	CL40MRS-B	16RTS-104M/16R23W	E1016-1605S
CL40MRSB-C	CL40MRS-C	16RTS-104M/16R23R	E1016-1602S
CL40MRSB-D	CL40MRS-D	16RTS-104M/16R23B	E1016-1612S
CL40MRSB-E	CL40MRS-E	16RTS-104M/16R23G	E1016-1604S
CL40FRSB-A	CL40FRS-A	16RTS-104F/16R24E	E1016-1631S
CL40FRSB-B	CL40FRS-B	16RTS-104F/16R24W	E1016-1636S
CL40FRSB-C	CL40FRS-C	16RTS-104F/16R24R	E1016-1633S
CL40FRSB-D	CL40FRS-D	16RTS-104F/16R24B	E1016-1643S
CL40FRSB-E	CL40FRS-E	16RTS-104F/16R24G	E1016-1635S
CL40MRB-A	CL40MR-A	16R55-104M/16R21E	E1016-1700
CL40MRB-B	CL40MR-B	16R55-104M/16R21W	E1016-1705
CL40MRB-C	CL40MR-C	16R55-104M/16R21R	E1016-1702
CL40MRB-D	CL40MR-D	16R55-104M/16R21B	E1016-1706
CL40MRB-E	CL40MR-E	16R55-104M/16R21G	E1016-1704
CL40FRB-A	CL40FR-A	16R55-104F/16R22E	E1016-1725
CL40FRB-B	CL40FR-B	16R55-104F/16R22W	E1016-1730
CL40FRB-C	CL40FR-C	16R55-104F/16R22R	E1016-1727
CL40FRB-D	CL40FR-D	16R55-104F/16R22B	E1016-1731
CL40FRB-E	CL40FR-E	16R55-104F/16R22G	E1016-1729
CPT	N/A	16PMMF/ 16A21	E1016-2324
CTT	N/A	16TMFF/ 16A22	E1016-2312
CA3F	N/A	16MFF/ 16A23	E1016-9500
CDFF	N/A	16VFFF/ 16A24	E1016-2352
CDMM	N/A	16MMM/16A25	N/A
CLM2M-A	N/A	15DS-468M/15D21E	E1015-8306
CLM2M-B	N/A	15DS-468M/15D21W	E1015-8308
CLM2M-C	N/A	15DS-468M/15D21R	E1015-8310
CLM2M-D	N/A	15DS-468M/15D21B	E1015-8311
CLM2M-E	N/A	15DS-468M/15D21G	E1015-8313
CLM2F-A	N/A	15DS-469F/15D22E	E1015-8331
CLM2F-B	N/A	15DS-469F/15D22W	E1015-8333
CLM2F-C	N/A	15DS-469F/15D22R	E1015-8335
CLM2F-D	N/A	15DS-469F/15D22B	E1015-83336
CLM2F-E	N/A	15DS-469F/15D22G	E1015-8338
CLMMRS-A	N/A	15RTS-468M/15R21E	E1015-1600
CLMMRS-B	N/A	15RTS-468M/15R21W	E1015-1602
CLMMRS-C	N/A	15RTS-468M/15R21R	E1015-1604
CLMMRS-D	N/A	15RTS-468M/15R21B	E1015-1605
CLMMRS-E	N/A	15RTS-468M/15R21G	E1015-1606
CLMFRS-A	N/A	15RTS-468F/15R22E	E1015-1625
CLMFRS-B	N/A	15RTS-468F/15R22W	E1015-1627
CLMFRS-C	N/A	15RTS-468F/15R22R	E1015-1629
CLMFRS-D	N/A	15RTS-468F/15R22B	E1015-1630
CLMFRS-E	N/A	15RTS-468F/15R22G	E1015-1631

ADI Stage Pin Devices	ROSCO	UNION	MOLE-RICHARDSON
20F	2240	20-2P&GFP	FC255G
20M	2210	20-2P&GMP	MC255G
20FR	2420	2P-&GF-FL	FPM255G
20MR	2250	2PG&GM-FL	MPM255G
20F-CP		20-2P&GFC	N/A
20M-CP		20-2P&GMC	N/A
60F	6410	N/A	N/A
60M	6210	N/A	N/A
60FR	6450	N/A	N/A
60MR	6250	N/A	N/A
100F	8410	N/A	N/A
100M	8210	N/A	N/A
100FR	8450	N/A	N/A
100MR	8250	N/A	N/A
106F	N/A	N/A	N/A
106M	N/A	N/A	N/A
106FR	N/A	N/A	N/A
106MR	N/A	N/A	N/A
G60F	N/A	60-2P&GF1	FC257G
G60M	N/A	60-2P&GM1	MC257G
G60FR	N/A	60-2P&GF-FL	FP257G
G60MR	N/A	60-2P&GM-FL	MP257G
G100F	N/A	100-2P&GF1	FC258G
G100M	N/A	100-2P&GM1	MC258G
G100FR	N/A	100-2P&GF-FL-B	FPM258G
G100MR	N/A	100-2P&GM-FL-B	MPM258G
G106F	N/A	100-2H&GF1	FC256G
G106M	N/A	100-2H&GM1	MC256G
G106FR	N/A	100-2H&GF-FL-B	FPM259G
G106MR	N/A	100-2H&GM-FL-B	MPM259G
G20F-FU	N/A	N/A	FC269G
G20M-FU	N/A	N/A	MC269G
G60F-FU	N/A	N/A	FC266G
G60M-FU	N/A	N/A	MC266G
G100F-FU	N/A	N/A	FC261G
G100M-FU	N/A	N/A	MC261G
G106F-FU	N/A	N/A	FC262G

## Product line listings and ratings

**bates**



**GROUP 5**

ETL

CL Series



CLS Series

**NEMA 3R NEMA 4R**



CLM Series

**NEMA 3R NEMA 4R**



## Color key for product number designation

**A B C D E F G H J X (CLEAR)**

## LIMITED WARRANTY

Advanced Devices, Inc. warrants that at the time of shipment, the products manufactured by Advanced Devices and sold hereunder shall be in conformity with applicable written specifications and descriptions referred to or set forth herein, free from defects in material and workmanship, merchantable, and suitable for a particular purpose, provided such is implied by state law under the circumstances of this sale.

The design and dimensions of the product listed in this catalog are subject to change without notice.